

SLIDE COMPONENTS:

NATURE'S INSTRUMENTS NI-PG-1005-01 DOUBLE RAIL LOG HILL SLIDE.
 NI PACKAGE INCLUDES:-

- 1220mm [48"] HT. LOG SLIDE WITH PRE-ATTACHED FRAME & COLLAR: x 1
- DUROLAWN MAT: x 4
- PRE-MITRED LOG BORDER: x 14.3 lin.m [4.7 lin.ft]
- LOG ENTRANCE PLATFORM: x 1
- CEDAR WING WALL (PRE-ASSEMBLED POST, RAILS & PICKETS): x 2
- CARRIAGE BOLT WITH NUTS & WASHERS: x 8
- SDWS SCREWS: x 9 - 14
- REBAR STAKE: x 1

STRUCTURAL FILL, SONOTUBES, CONCRETE, GRAVEL, ENGINEERED WOOD FIBRE, GEO-TEXTILE, SOIL, PLANTS & MULCH ARE NOT SUPPLIED.

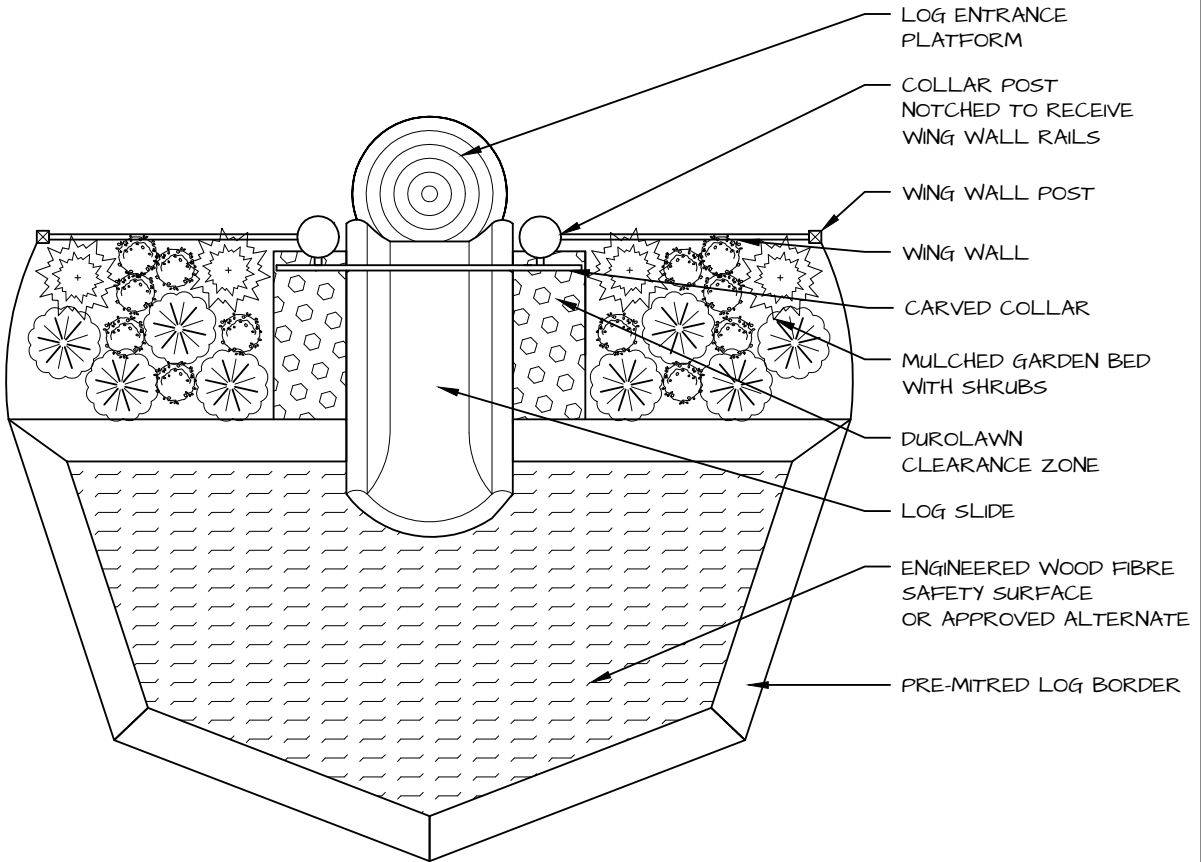

DETAIL

4' CARVED LOG HILL SLIDE

PRODUCT NUMBER	PAGE	SCALE @ .05x1	DRAWN	CHECKED	PHONE NUMBER
NI-PG-1005-01	1 OF 9	NT.S.	SE	SE	1-877-733-7459

COPYRIGHT © 2016 NATURE'S INSTRUMENTS. DO NOT SCALE DRAWINGS. NOT FOR COMMERCIAL USE OR REPRINT WITHOUT EXPRESSED WRITTEN PERMISSION FROM NATURE'S INSTRUMENTS.

SLIDE LAYOUT:

1. HEIGHT OF SLIDE MAY VARY BY UP TO 150mm [6"] BASED ON THE NATURAL QUALITIES OF THE LOG.
2. LENGTH OF SLIDE IS APPROXIMATE AND MAY VARY BY UP TO 300mm [12"] BASED ON THE NATURAL QUALITIES OF THE LOG.
3. ADJUST LAYOUT AND GRADING ON SITE ACCORDING TO THE PHYSICAL LOG SLIDE.
4. LAYOUT SLIDE SO THAT THE SLIDE EXIT IS IN THE REQUIRED LOCATION TO ALLOW FOR THE LOG BORDER TO FIT WITHIN THE LAYOUT.
5. THE LOG BORDER WILL ADD APPROX. 2500mm [98"] DIRECTLY OUT FROM THE EXIT OF THE SLIDE.

HILL CONSTRUCTION:

1. UNDER THE SLIDE FRAME A MATERIAL SUCH AS HIGH PERFORMANCE BEDDING (H.P.B.) SHOULD BE USED TO ACHIEVE 95% S.P.D.D. COMPACTION WITHOUT NEEDING TO MECHANICALLY COMPACT THE MATERIAL.
2. AROUND THE BACK AND SIDES OF THE SLIDE A STRUCTURAL FILL SHOULD BE USED THAT CAN ACHIEVE 98% S.P.D.D.

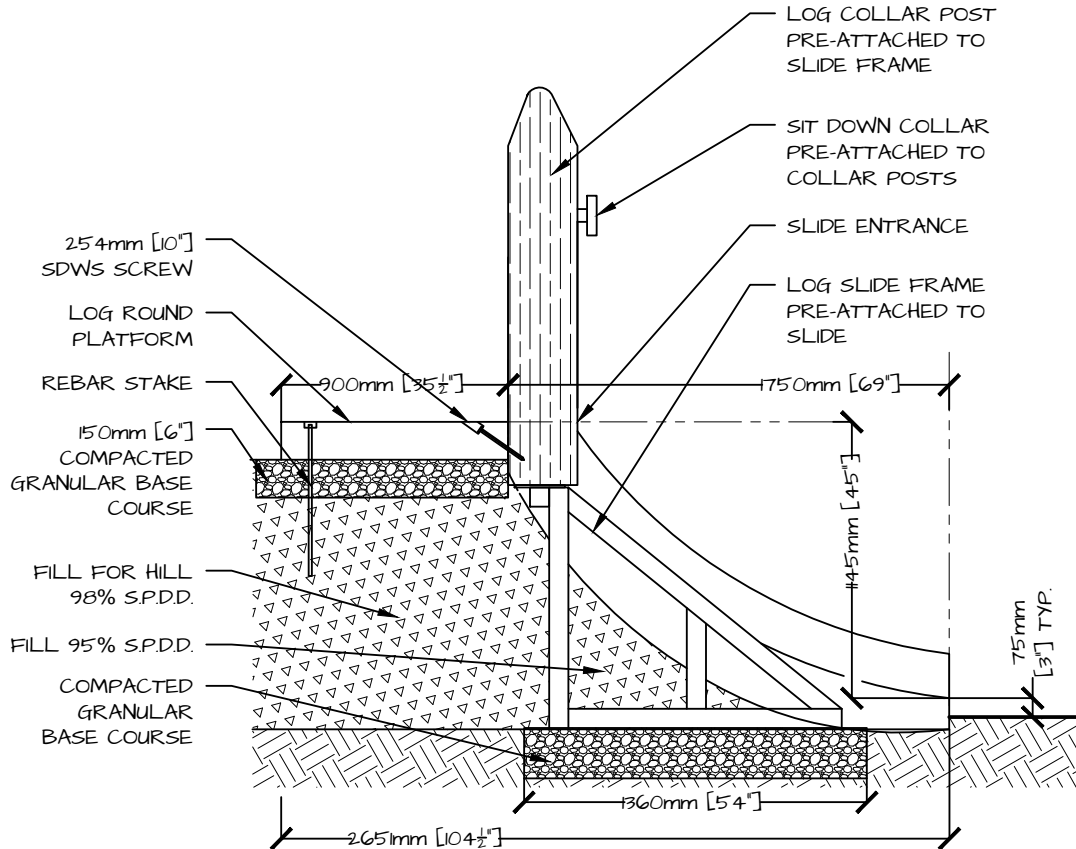

- SIDE SECTION: SLIDE FRAME -



DETAIL

4' CARVED LOG HILL SLIDE

PRODUCT NUMBER	PAGE	SCALE @ .05x1	DRAWN	CHECKED	PHONE NUMBER
NI-PG-1005-01	2 OF 9	NT.S.	SE	SE	1-877-733-7459

SLIDE INSTALLATION:

1. PLACE SLIDE IN POSITION ACCORDING TO LAYOUT.
2. SLIDE TO SIT ON 200mm [8"] 150mm [6"] MIN. DEPTH OF CRUSHED GRAVEL (OR 3/4" CLEAR GRAVEL) COMPACTED TO 98% SPDD.
- 2.1. DIMENSIONS OF GRANULAR BASE COURSE TO BE AT LEAST 200 x 100 x 1360 mm [8" x 4" x 54"].
3. BACKFILL INSIDE THE SLIDE FRAME WITH H.P.B. OR OTHER MATERIAL THAT CAN ACHIEVE 95% SPDD.
4. CONTINUE BUILDING HILL ACCORDING TO GRADING PLAN.
5. THE SLOPE OF THE GRAVEL BASE ALONG THE SIDES OF THE SLIDE SHOULD REMAIN 300 - 450mm [12" - 18"] BELOW THE SIDE EDGES OF THE SLIDE.

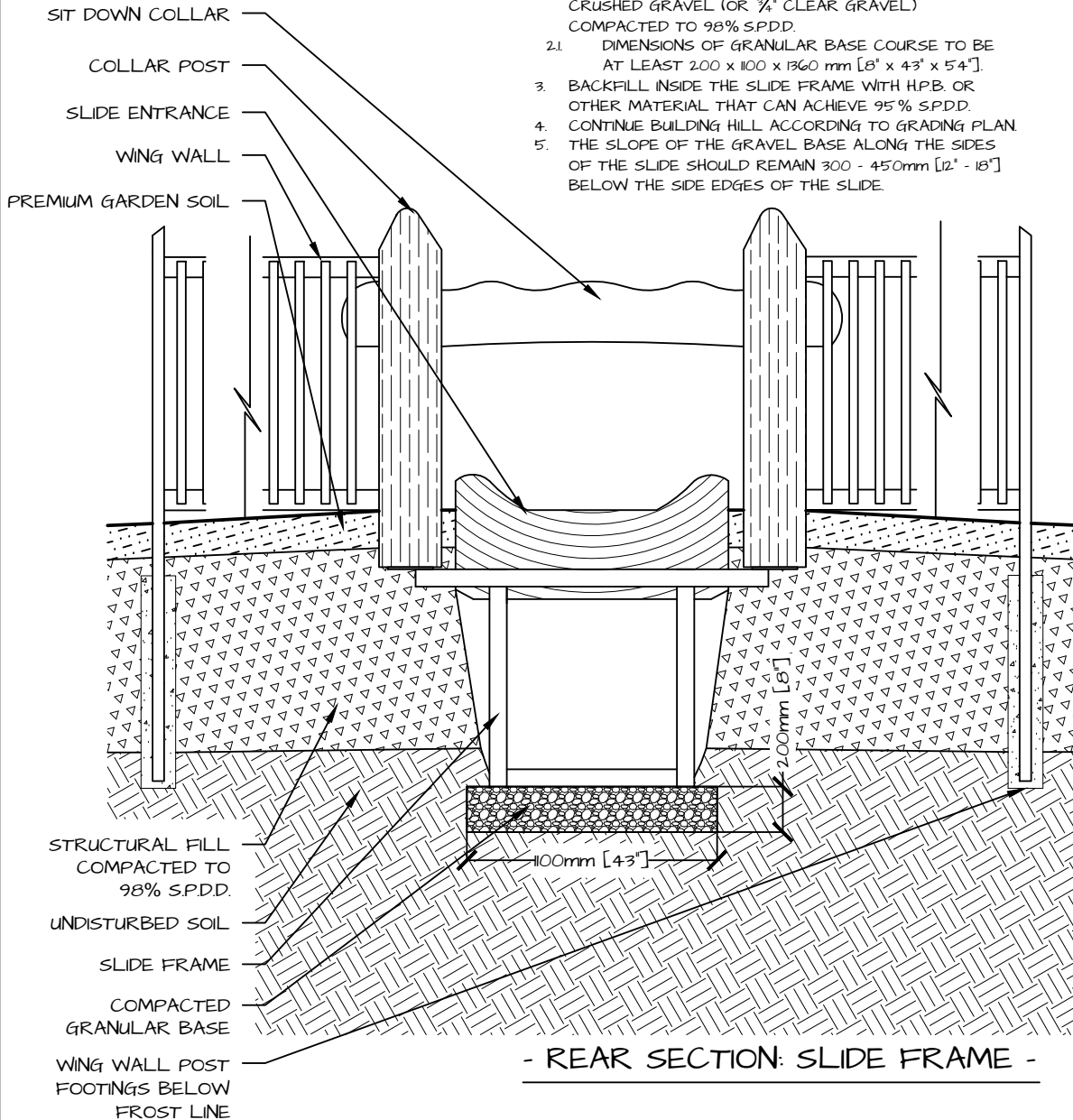

- REAR SECTION: SLIDE FRAME -



DETAIL

4' CARVED LOG HILL SLIDE

PRODUCT NUMBER	PAGE	SCALE @ .05x1	DRAWN	CHECKED	PHONE NUMBER
NI-PG-1005-01	3 OF 9	NT.S.	SE	SE	1-877-733-7459

PLANTING BEDS:

1. FILL PLANTING BEDS WITH AT LEAST 300mm [12"] DEPTH PREMIUM ORGANIC GARDEN SOIL UP TO 100mm [4"] BELOW FINISHED GRADE.
2. GARDEN SOIL SHOULD OVERLAP THE DUROLAWN MAT AND BE EVEN WITH THE EDGE OF THE SOD.
3. ALL SHRUBS ARE IDENTICAL ON EACH SIDE OF SLIDE.
4. THE SIZE OF SHRUB SYMBOLS SHOWN ON THE PLANTING PLAN ARE INDICATIVE OF ROOT-BALL SIZE, NOT DRIPLINE.
5. THE PLANTING DESIGN FOR THE GARDEN BEDS AROUND THE HILL-SLIDE ARE DELIBERATELY OVER-PLANTED TO INFLUENCE THE TRAFFIC-PATTERN OF CHILDREN PLAYING ON THE SLIDE FROM THE FIRST DAY OF INSTALLATION.
6. SHRUBS ARE NOT TO BE PLANTED INTO DUROLAWN.
7. AFTER PLANTING, TOP GARDEN BED WITH 100mm [4"] OF MULCH.

RECOMMENDED PLANT LIST:

THE FOLLOWING SHRUBS ARE RECOMMENDATIONS ONLY; SPECIFIC SPECIES SELECTION IS DEPENDANT ON LOCAL SITE CONDITIONS.

- *Acer rubrum* / Multi-stemmed Red Maple (OR SIMILAR)
2m HEIGHT, CLUMP FORM: x2
- *Amelanchier canadensis* / Multi-stemmed Serviceberry (OR SIMILAR)
2m HEIGHT, CLUMP FORM: x6
- *Rhus typhina* / Staghorn Sumac (OR SIMILAR)
1 GAL POT: x6
- *Salix caprea* / Pussy Willow (OR SIMILAR)
3 GAL POT: x6
- *Thuja occidentalis* / White Cedar (OR SIMILAR)
2m HEIGHT: x4

PLANTINGS ALONG THE SIDE OF THE SLIDE MAY NOT ENCR OACH ON THE DUROLAWN CLEARANCE ZONE

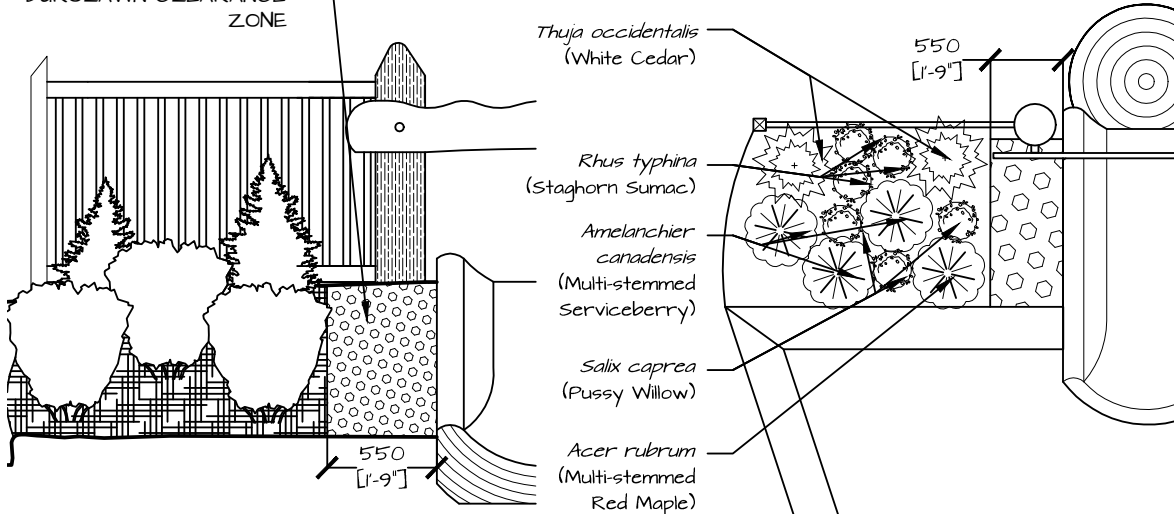

- ELEVATION: PLANTING -

- PLAN: PLANTING -



DETAIL

4' CARVED LOG HILL SLIDE

PRODUCT NUMBER	PAGE	SCALE @ .05X	DRAWN	CHECKED	PHONE NUMBER
NI-PG-1005-01	4 OF 9	NT.S.	SE	SE	1-877-733-7459

GRADING:

1. WITHIN 1220 - 1525mm [48" - 60"] FROM THE EDGE OF THE SLIDE, THE FINISHED GRADE OF THE HILL IS TO BE CONTOURED TO MATCH THE SLOPE OF THE SLIDE.
2. OUTSIDE OF THE 1220 - 1525mm [48" - 60"] ZONE THE GRADE SHALL SMOOTHLY TRANSITION INTO THE SURROUNDING HILL.
3. THE CONTOURS SHOWN BELOW ARE AN EXAMPLE OF THE SHAPE OF THE HILL ON THE SIDES OF THE SLIDE.
4. IN GENERAL, THE GRADE SHOULD BE GRADUAL AND WITH AN OVERALL CONCAVE SHAPE.

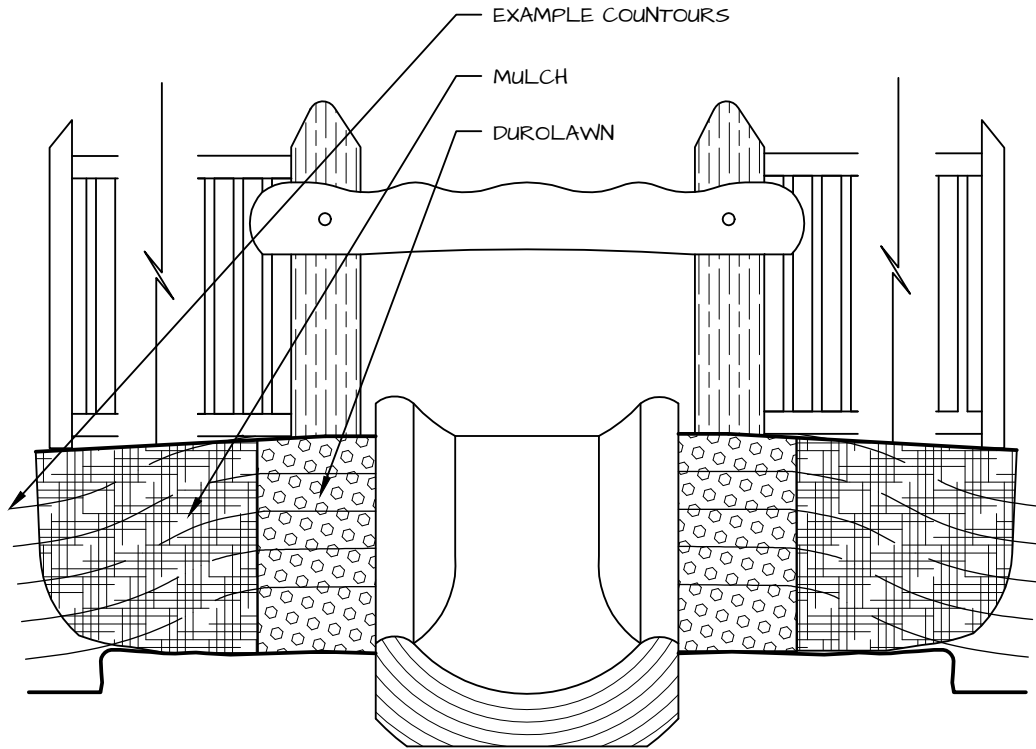

- ELEVATION: HILL GRADING -



DETAIL

4' CARVED LOG HILL SLIDE

PRODUCT NUMBER	PAGE	SCALE @ .05x1	DRAWN	CHECKED	PHONE NUMBER
NI-PG-1005-01	5 OF 9	NT.S.	SE	SE	1-877-733-7459

COPYRIGHT © 2016 NATURE'S INSTRUMENTS. DO NOT SCALE DRAWINGS. NOT FOR COMMERCIAL USE OR REPRINT WITHOUT EXPRESSED WRITTEN PERMISSION FROM NATURE'S INSTRUMENTS.

DUROLAWN INSTALLATION:

1. A STRIP OF DUROLAWN AT LEAST 525mm [21"] WIDE IS TO BE INSTALLED ALONG EACH SIDE OF THE SLIDE.
2. DUROLAWN IS A RUBBER MAT GRASS PROTECTION SYSTEM, IMPACT RATED FOR A FALL HEIGHT UP TO 2438mm [96"].
3. DUROLAWN IS MAINTAINED IN THE SAME MANNER AS TYPICAL GRASS.
4. IT IS SUGGESTED THAT THE GRASS AND DUROLAWN ALONG THE SIDES OF THE SLIDE BE LEFT ALONE TO GROW LONG WITH NO MAINTENANCE.
5. GO TO www.durolawn.com FOR MORE INFORMATION.
6. SLIDE THE EDGE OF THE DUROLAWN MAT 150 - 200mm [6" - 8"] UNDERNEATH THE SIDES OF THE SLIDE.
7. ROLL THE REST OF THE DUROLAWN MAT OUT OF THE WAY OVER THE SIDES OF THE SLIDE.
8. INSTALL LANDSCAPE SOIL ON THE HILL 600mm [24"] FROM THE EDGES OF THE SLIDE & COMPACT. ENSURE THE TOP OF THE SOIL IS 50mm [2"] BELOW FINISHED GRADE.
9. INSTALL A 600mm [24"] WIDE STRIP OF SOD ON THE LANDSCAPE SOIL.
10. ROLL DUROLAWN MATS BACK OVER THE SOD AND LET THE EXCESS MAT ROLL DOWN THE EDGE OF THE LANDSCAPE SOIL.

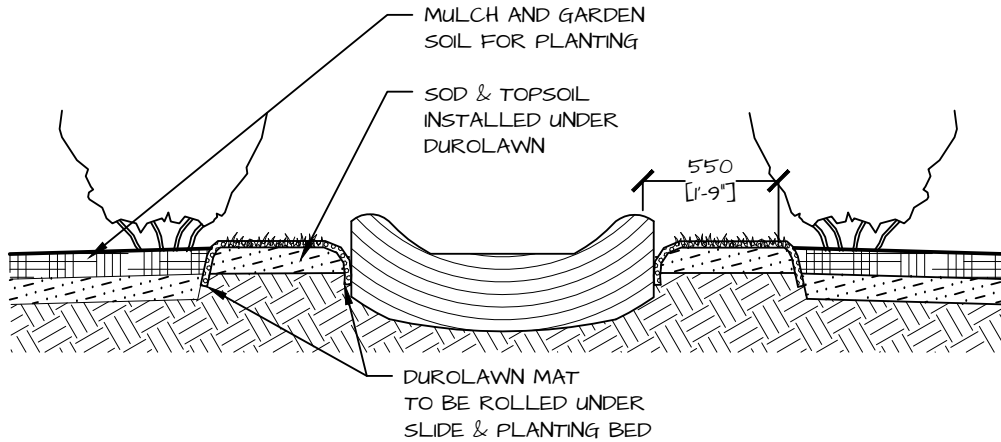
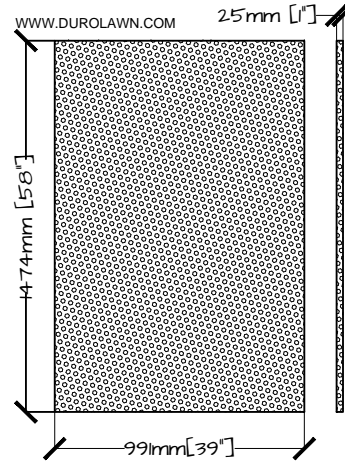

- SECTION: SURFACING ADJACENT TO SLIDE -



DETAIL

4' CARVED LOG HILL SLIDE

PRODUCT NUMBER	PAGE	SCALE @ .85x1	DRAWN	CHECKED	PHONE NUMBER
NI-PG-1005-01	6 OF 9	NT.S.	SE	SE	1-877-733-7459

WING WALLS:

1. WING WALLS TO BE INSTALLED WITH PICKETS FACING THE SLIDE ENTRANCE SIDE OF THE SLIDE (TOP OF HILL).
2. DEPENDING ON THE SHAPE AND TYPE OF FINISHED SURFACE ON THE HILL, A BARRIER MAY BE INSTALLED BETWEEN THE WING WALL POST AND THE COLLAR POST TO RETAIN A MINIMAL AMOUNT OF MATERIAL FROM SLIDING INTO THE GARDEN BEDS.
3. WING WALL POSTS WILL BE APPROX 1850mm [73"] FROM THE COLLAR POSTS.
4. ENSURE THAT WHEN WING WALL RAILS ARE POSITIONED IN THE NOTCHES OF THE COLLAR POSTS THE WING WALL POSTS REACH THE CENTRE OF THE FOOTING HOLES.
5. DIG HOLES FOR 254mm [10"] Ø SONOTUBES TO AT LEAST 1220mm [48"] BELOW FINISHED GRADE, I.E. BELOW THE FROST LINE
6. INSTALL WING WALL SECTIONS:
 - 6.1. PLACE RAILS INTO NOTCHES IN COLLAR POSTS.
 - 6.2. INSTALL SCREWS IN PRE-DRILLED HOLES IN RAILS TO FASTEN TO COLLAR POSTS.
 - 6.3. SUSPEND WING WALL POSTS IN SONOTUBES.
 - 6.4. LEVEL THE RAILS AND PLUMB THE POST.
 - 6.5. INSTALL CONCRETE.

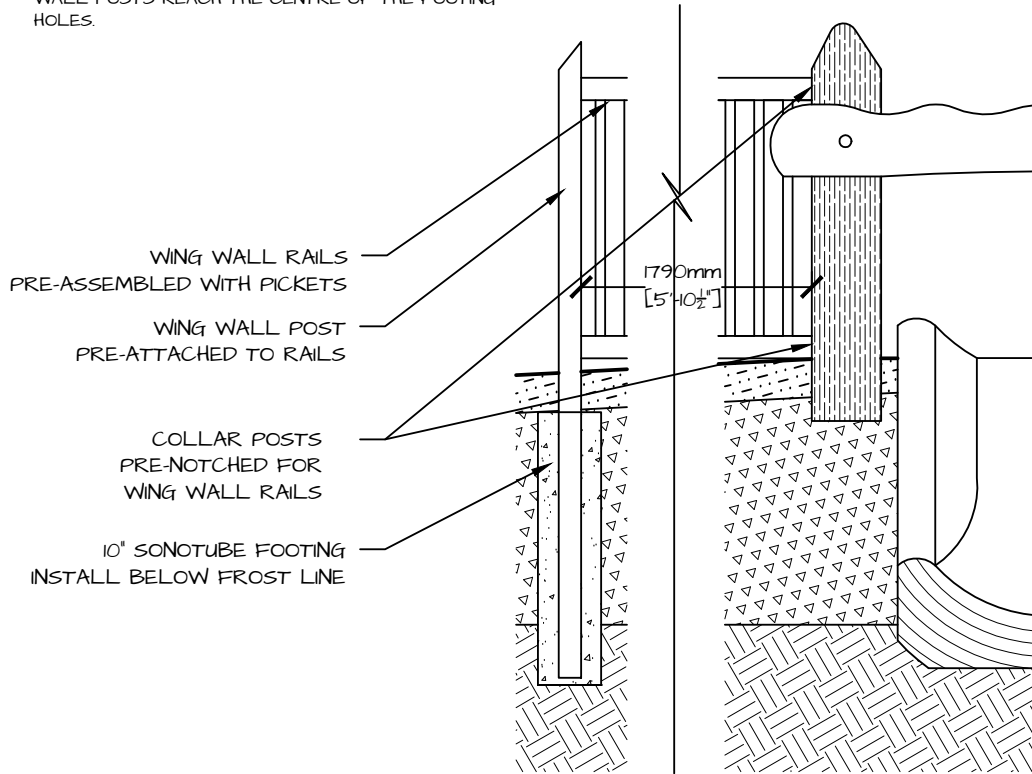

- SECTION: WING WALLS -



DETAIL

4' CARVED LOG HILL SLIDE

PRODUCT NUMBER	PAGE	SCALE @ .85x1	DRAWN	CHECKED	PHONE NUMBER
NI-PG-1005-01	7 OF 9	N.T.S.	SE	SE	1-877-733-7459

COPYRIGHT © 2016 NATURE'S INSTRUMENTS. DO NOT SCALE DRAWINGS. NOT FOR COMMERCIAL USE OR REPRINT WITHOUT EXPRESSED WRITTEN PERMISSION FROM NATURE'S INSTRUMENTS.

ENTRANCE PLATFORM:

1. LOG ROUND PLATFORM IS 150mm [6"] THICK
2. INSTALL 150mm [6"] MIN. DEPTH OF CRUSHED GRAVEL (OR ¾" CLEAR GRAVEL) COMPACTED TO 98% SPDD. BELOW THE PLATFORM.
3. POSITION PLATFORM SO THAT THE FLAT EDGE IS FLUSH AGAINST TOP OF SLIDE.
4. ENSURE THAT PLATFORM IS PERFECTLY LEVEL WITH TOP OF SLIDE LEFT TO RIGHT AND FRONT TO BACK.
5. INSTALL SUPPLIED S.D.W.S. SCREWS IN PRE-DRILLED HOLES FASTENING PLATFORM TO SLIDE.
6. INSTALL SUPPLIED REBAR STAKE AT REAR OF PLATFORM.
7. GLUE PLUGS INTO COUNTERSUNK HOLES AND SAND THEM FLUSH WITH PLATFORM.

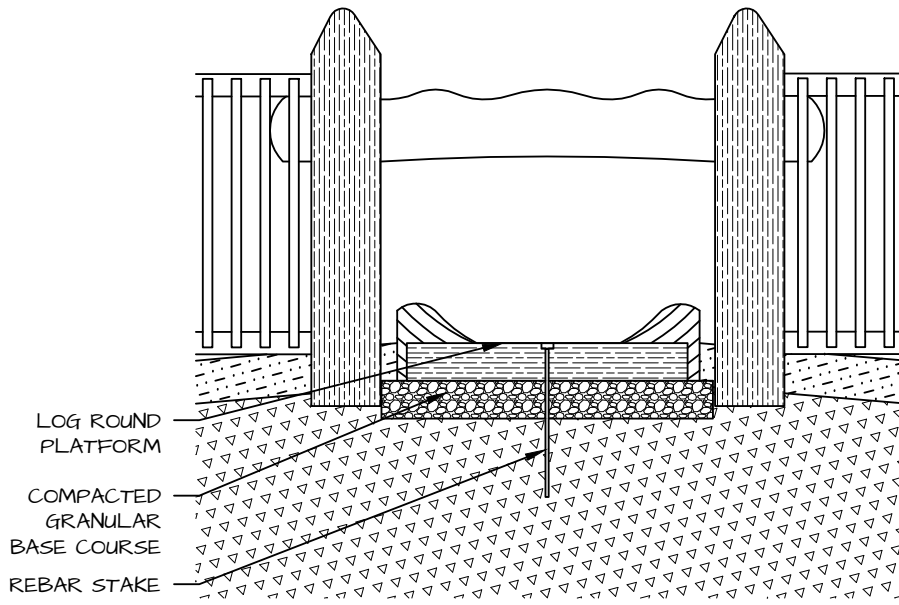

- SECTION: ENTRANCE PLATFORM -



DETAIL

4' CARVED LOG HILL SLIDE

PRODUCT NUMBER	PAGE	SCALE @ .05x1	DRAWN	CHECKED	PHONE NUMBER
NI-PG-1005-01	8 OF 9	N.T.S.	SE	SE	1-877-733-7459

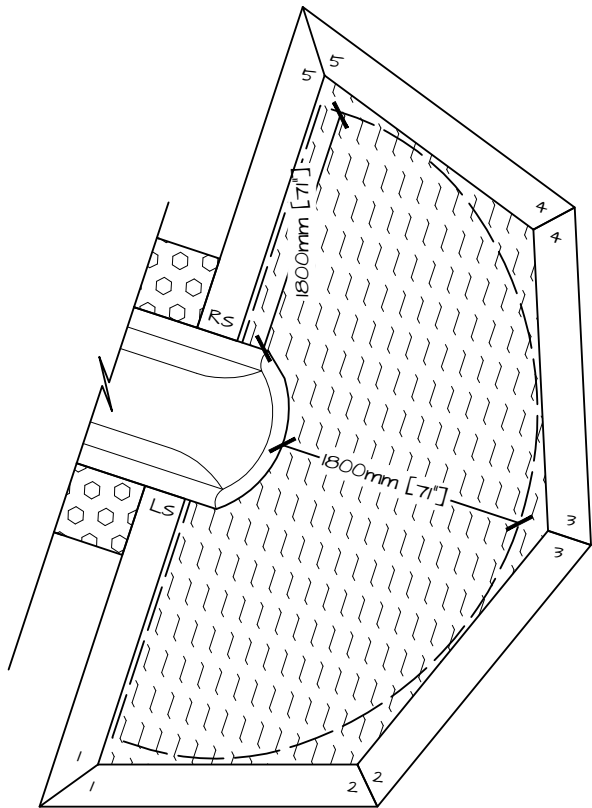

- PLAN: SAFETY SURFACING -

SAFETY SURFACING:

1. 300mm [12"] OF ENGINEERED WOOD FIBRE (E.W.F.) OR APPROVED EQUAL TO BE INSTALLED AT BASE OF SLIDE WITHIN LOG BORDER.
2. INSTALL E.W.F. ACCORDING TO MANUFACTURER'S RECOMMENDATIONS.
3. E.W.F. MAY REQUIRE A 300mm [12"] PERCOLATION BED FOR DRAINAGE.

LOG BORDER:

1. LOG BORDER COMES PRE-MITERED.
2. ALL MITERS ARE LABELED TO MATCH EACH OTHER.
3. POSITION LOGS LABELED 'Ls' & 'Rs' SO THEY ARE PERPENDICULAR TO THE SLIDE.
4. PLACE LOGS BY MATCHING NUMBERS AND ALIGNING THE MITERED EDGES.
5. LOGS MUST BE PLACED OUTSIDE OF THE PROTECTIVE SAFETY ZONE. (SEE LAYOUT).
6. LOGS TO BE BURIED AT LEAST 1/3 THEIR HEIGHT.
7. FASTEN MITERS TOGETHER WITH SDWS SCREWS IN PRE-DRILLED AND COUNTERSUNK HOLES.
8. JOINTS BETWEEN LOGS SHALL NOT EXCEED 15mm [1/2"]
9. ENSURE THE LOGS MEET THE EDGES OF THE SLIDE AND TOP OF THE LOGS ARE LEVEL WITH THE RAILS OF THE SLIDE.

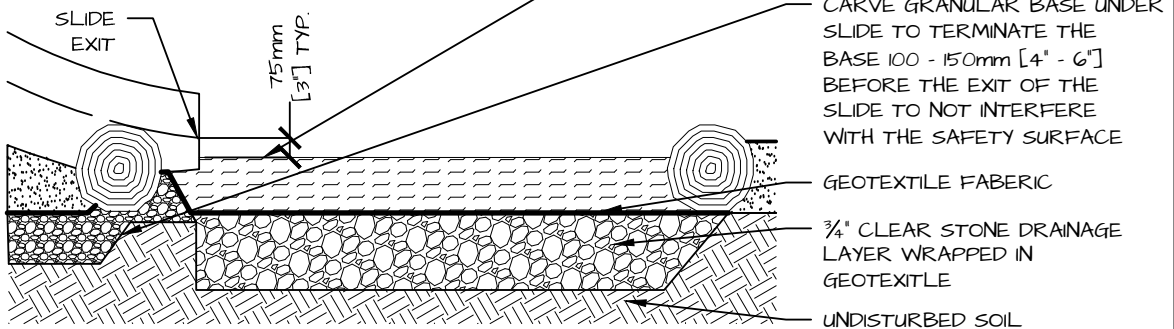

- SECTION: SAFETY SURFACING -

ENGINEERED WOOD FIBRE FINISHED GRADE SHALL BE 0 - 175mm [0" - 7"] BELOW THE SLIDE EXIT
75mm [3"] IS RECOMMENDED

CARVE GRANULAR BASE UNDER SLIDE TO TERMINATE THE BASE 100 - 150mm [4" - 6"] BEFORE THE EXIT OF THE SLIDE TO NOT INTERFERE WITH THE SAFETY SURFACE

GEOTEXTILE FABRIC

3/4" CLEAR STONE DRAINAGE LAYER WRAPPED IN GEOTEXTILE

UNDISTURBED SOIL



DETAIL

4' CARVED LOG HILL SLIDE

PRODUCT NUMBER	PAGE	SCALE @ 05x1	DRAWN	CHECKED	PHONE NUMBER
NI-PG-1005-01	9 OF 9	N.T.S.	SE	SE	1-877-733-7459

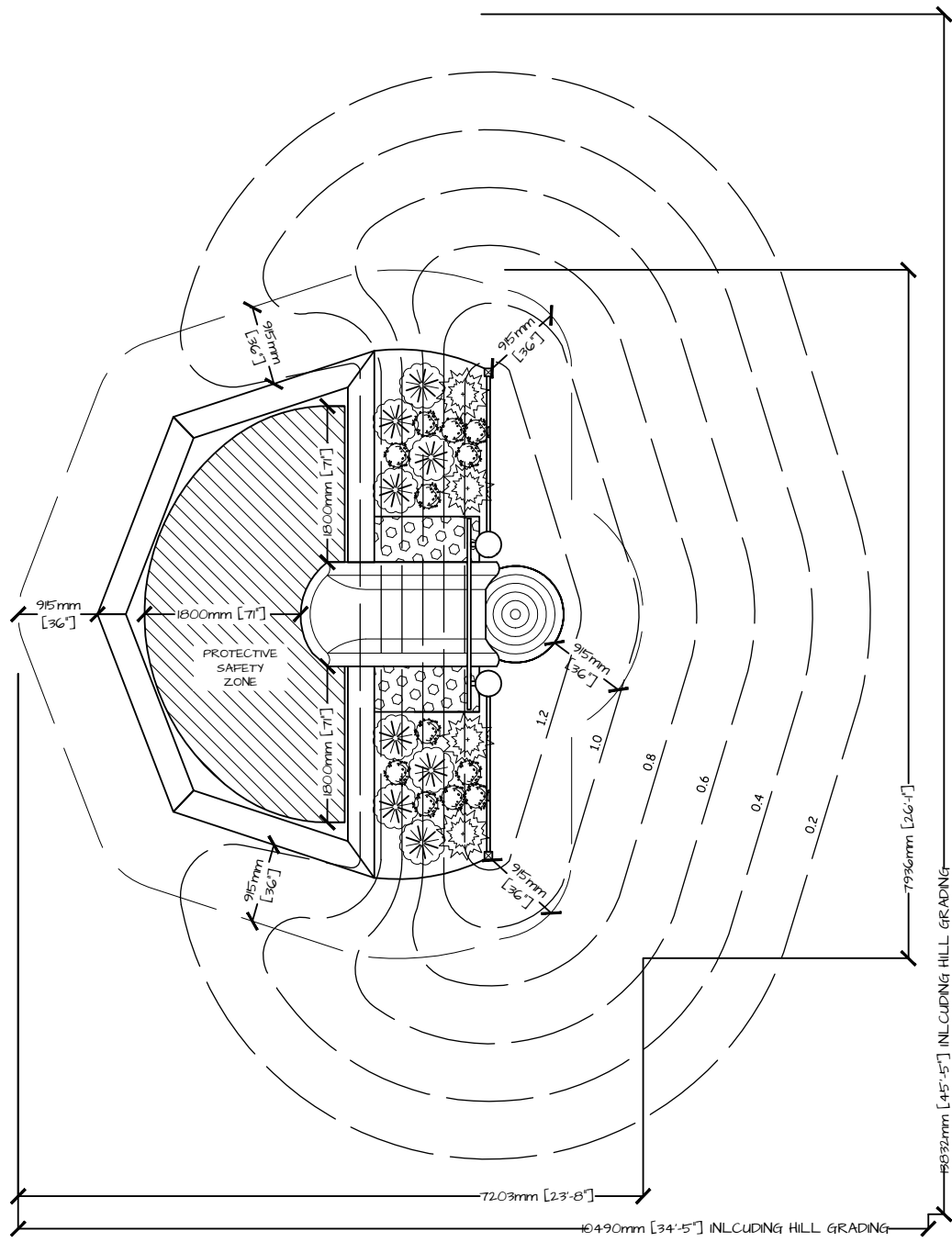

DETAIL

4' CARVED LOG HILL SLIDE - LAYOUT

PRODUCT NUMBER	PAGE	SCALE @ 215x1	DRAWN	CHECKED	PHONE NUMBER
NI-PG-1005-01	1 OF 1	NT.S.	SE	SE	1-877-733-7459

COPYRIGHT © 2016 NATURE'S INSTRUMENTS. DO NOT SCALE DRAWINGS. NOT FOR COMMERCIAL USE OR REPRINT WITHOUT EXPRESSED WRITTEN PERMISSION FROM NATURE'S INSTRUMENTS.